

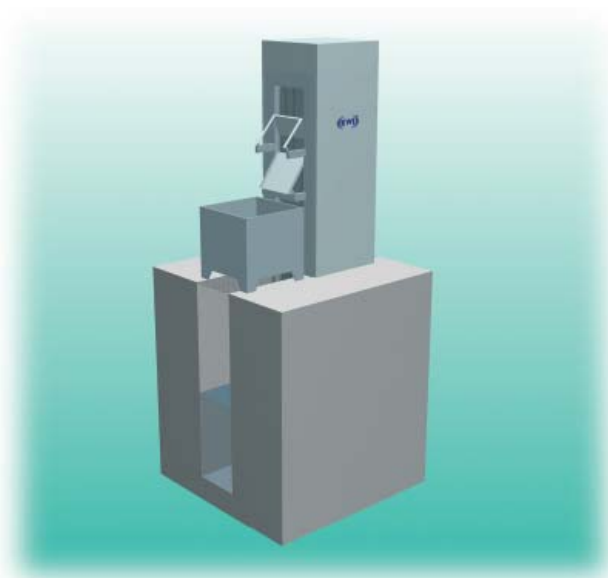

DC Screen

Vertical fine screen for channels and collectors



A unique technology allowing fine screening :

- with no limits in the channel depth,
- with no mechanical stresses related to the narrow distance between the bars,
- a very competitive price, make of this screen a perfectly performing and reliable piece of equipment.

Main advantages :

- Fine screening (down to 3 mm) for a waste discharge height above 10 meters.
- Strong and reliable construction entirely in Stainless Steel.
- Smooth operation without hitches.
- Large quantity of waste scraped per cycle - the teeth of the scraper are 150 mm long and can lift solids up to 300 mm.
- Cleaning from downstream avoiding accumulation of wastes on the scraper.
- No water required for cleaning.
- Vertical installation - very little space occupied.
- Easy to install in existing channels.
- Low cross-sectional area and low head-losses.
- Competitive price for this level of screening.

Main applications :

- Screening of channels transporting municipal or industrial waste-water.
- Screening of waste water or rain water collectors.
- Screening in water capture and irrigation channels.

The operation of the **DC Screen** is based on a patented technology. The cleaning is made from the downstream side by means of a scraper. The teeth of the scraper are guided by the bars of the screen. This self-guiding of the scraper allows the distance between the bars to be reduced to 3 mm and avoids the mechanical problems associated with such small tolerances in traditional bar screens.

The DC Screen is available with bars up to 3 mm apart. The width is from 400 to 2000 mm and the height of discharge of the wastes is over 10 m.

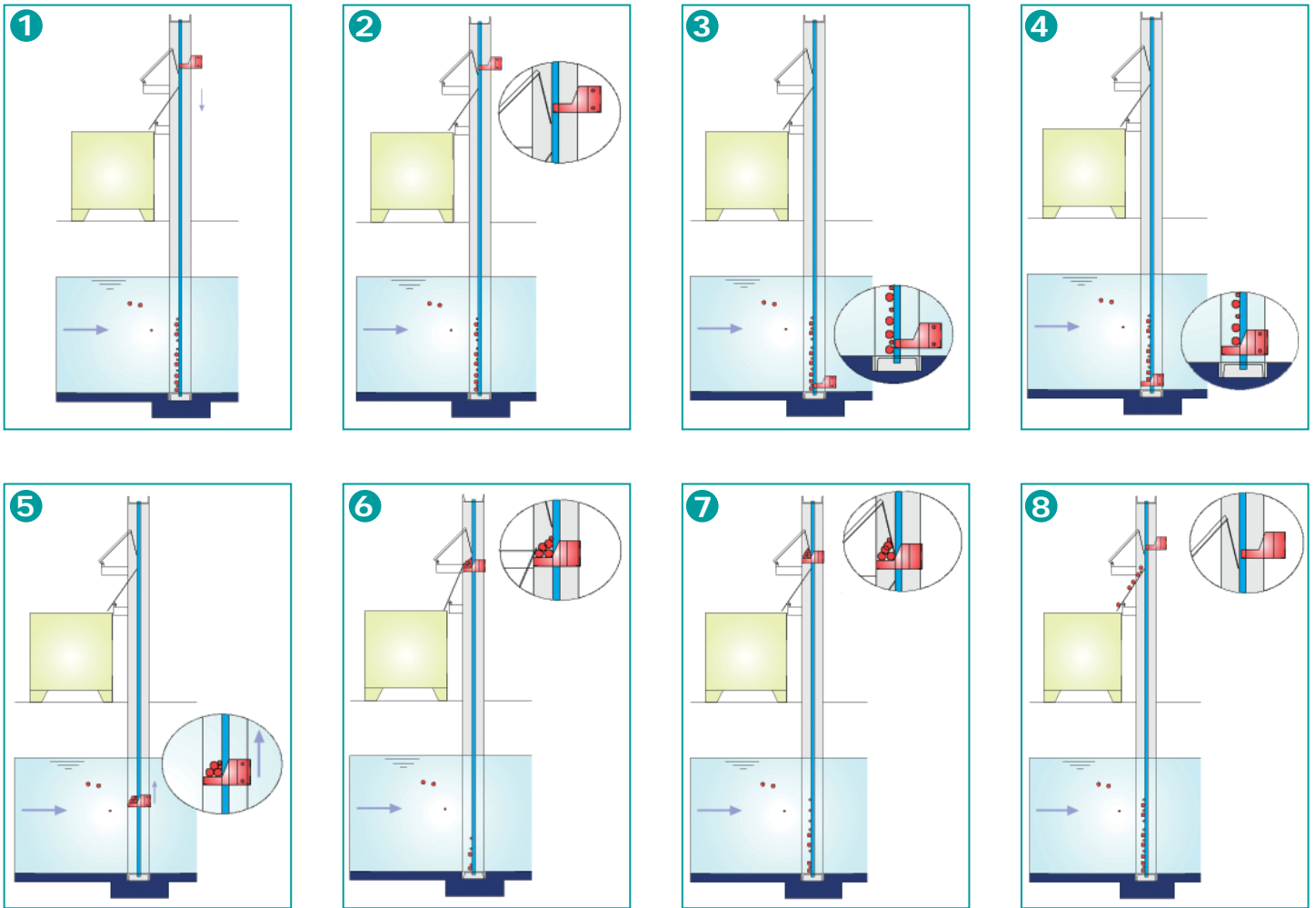
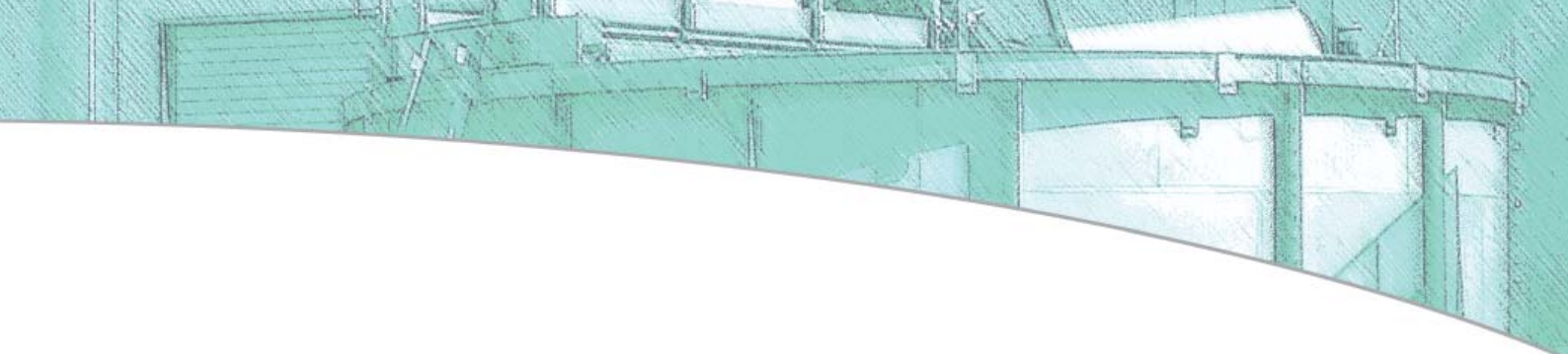

After the cleaning cycle the scraper is back in stand-by position at the top of the screen. Every sequence of the movement during the cleaning is controlled to avoid any risk of blocking.

KWI - Engineering

Acti-village, lot 15 - F-69500 Bron - France
Tél. : +33 (0)4 72 37 05 42 - Fax : +33 (0)4 72 37 82 46
Email : info.france@kwi-intl.com

KWI - Operations Headquarters

KWI International Environmental Treatment GmbH.
Auengasse 8 - A-9170 Ferlach - Austria
Tél. : +43 4227 3266 - Fax : +43 4227 3449
Email : info.austria@kwi-intl.com



www.kwi-intl.com



Atelier de fabrication ISO 9001 / 14001

Copyright KWI International Environmental Treatment GmbH.
All Rights Reserved.

No part of this material and/or brochure/catalogue may be reproduced, stored in a retrieval system, or transmitted in any form or by any means, electronic, mechanical, photocopying, recording or otherwise, without the prior permission of KWI International Environmental Treatment GmbH.

All trademark, marks, indicia, logo, trade name brand name contain in this brochure/catalogue belong to KWI International Environmental Treatment GmbH.